



Mikro Scheren  
Micro Scissors  
Micro Ciseaux  
Micro Tijeras  
Micro Forbici

Sehnen-Scheren  
 Tendon Scissors  
 Ciseaux tendons  
 Tijeras tendones  
 Forbici tendini

Iridektomiescheren  
 Iridectomy Scissors  
 Ciseaux à iridetomie  
 Tijeras para iridectomia  
 Forbici per iridectomia



spitz  
 sharp  
 pointu  
 agudo  
 appuntato



stumpf  
 blunt  
 mousse  
 romo  
 smusso

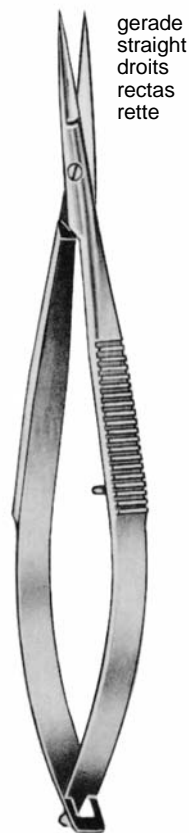

gerade  
 straight  
 droits  
 rectas  
 rette

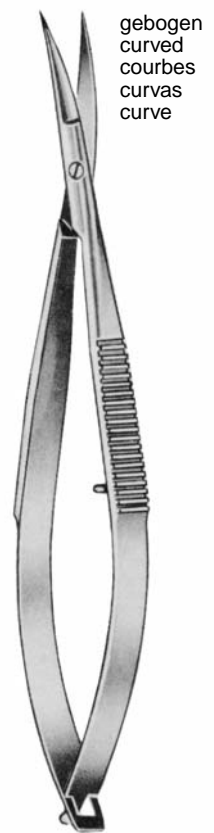

gebogen  
 curved  
 courbes  
 curvas  
 curve

cm WESTCOTT  
 11,0 09102.11

cm WESTCOTT  
 11,0 09104.11

cm WESTCOTT  
 11,0 09106.11

cm WESTCOTT  
 11,0 09107.11

Sehnen-, Iris-Scheren  
 Tendon, Iris Scissors  
 Ciseaux à iris et tendons  
 Tijeras iris y para tendones  
 Forbici per iride e tendini



cm	NOYES
13,0	09109.13
16,0	09109.16



Fig. 1

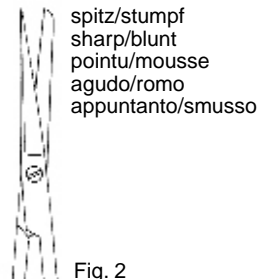

Fig. 2

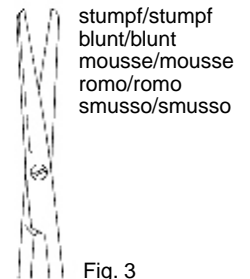

Fig. 3

cm	NOYES
12,0	09110.12

cm	NOYES
12,0	09111.12

cm	NOYES
12,0	09112.12

Sehnen-, Iris-Scheren  
 Tendon, Iris Scissors  
 Ciseaux à iris et tendons  
 Tijeras iris y para tendones  
 Forbici per iride e tendini

spitz/spitz  
 sharp/sharp  
 pointu/pointu  
 agudo/agudo  
 appuntato/appuntato

spitz/stumpf  
 sharp/blunt  
 pointu/mousse  
 agudo/romo  
 appuntato/smusso

stumpf/stumpf  
 blunt/blunt  
 mousse/mousse  
 romo/romo  
 smusso/smusso



cm WECKER  
 11,0 09113.11

cm WECKER  
 11,0 09115.11

cm WECKER  
 11,0 09117.11

cm WECKER  
 11,0 09113.11 - 09117.11



spitz  
 sharp  
 pointu  
 agudo  
 appuntato



stumpf  
 blunt  
 mousse  
 romo  
 smusso

Blattlänge 10 mm  
 length of blades 10 mm  
 longueur des lames 10 mm  
 largo de hojas 10 mm  
 lunghezza della lama 10 mm



cm McPherson-Westcott  
 10,0 09118.01

cm McPherson-Westcott  
 10,0 09118.02

cm BARRAQUER  
 5,5 09119.10

Iridektomie, Hornhaut  
 Iridectomy, corneal  
 Iridectomie, cornéens  
 Iridectomía, corneal  
 Iridectomia, corneale



cm McGUIRE  
 10,0 09121.10



spitz  
 sharp  
 pointu  
 agudo  
 appuntato

cm CASTROVIEJO  
 10,0 09133.10



stumpf  
 blunt  
 mousse  
 romo  
 smusso

cm CASTROVIEJO  
 10,0 09135.10



gerade  
 straight  
 droits  
 rectas  
 rette

cm VANNAS  
 8,0 09140.08



gebogen  
 curved  
 courbes  
 curvas  
 curve

cm VANNAS  
 8,0 09141.08



kniegebogen  
 angular  
 coudés  
 acodadas  
 angolate

cm VANNAS  
 8,0 09143.08

Iridektomie, Hornhaut  
 Iridectomy, corneal  
 Iridectomie, cornéens  
 Iridectomía, corneal  
 Iridectomia, corneale



links  
 left  
 gauche  
 izquierda  
 sinistra

cm CASTROVIEJO  
 10,0 09147.10



rechts  
 right  
 droite  
 derecha  
 destra

cm CASTROVIEJO  
 10,0 09149.10



stumpf  
 blunt  
 mousse  
 romo  
 smusso

cm CASTROVIEJO  
 11,0 09151.11



stumpf  
 blunt  
 mousse  
 romo  
 smusso

cm CASTROVIEJO  
 11,0 09153.11



stumpf  
 blunt  
 mousse  
 romo  
 smusso

cm CASTROVIEJO  
 11,0 09155.11

Mikrochirurgie  
 Micro Surgery  
 Microchirurgie  
 Microcirugía  
 Microchirurgia



cm  
 10,0 09157.10



rechts  
 right  
 droite  
 derecha  
 destra

cm TROUTMAN-CASTROVIEJO  
 11,0 09161.11



links  
 left  
 gauche  
 izquierda  
 sinistra

cm TROUTMAN-CASTROVIEJO  
 11,0 09163.11



gerade  
 straight  
 droits  
 rectas  
 rette

cm  
 14,0 09202.14  
 18,0 09202.18



gebogen  
 curved  
 courbes  
 curvas  
 curve

cm  
 14,0 09203.14  
 18,0 09203.18



gerade  
 straight  
 droits  
 rectas  
 rette

cm  
 18,0 09204.18



stumpf  
 blunt  
 mousse  
 romo  
 smusso

cm  
 18,0 09205.18



spitz  
sharp  
pointu  
agudo  
appuntato



spitz  
sharp  
pointu  
agudo  
appuntato



stumpf  
blunt  
mousse  
romo  
smusso

cm  
14,5 09220.14  
18,0 09220.18  
23,0 09220.23

cm  
14,5 09221.14  
18,0 09221.18  
23,0 09221.23

cm  
14,5 09223.14  
18,0 09223.18





09224.25  
 25°  
 18 cm

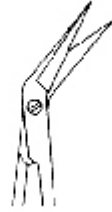

09224.45  
 45°  
 18 cm



09224.60  
 60°  
 18 cm



09224.90  
 90°  
 18 cm



09225.00  
 125°  
 18 cm

spitz  
 sharp  
 pointu  
 agudo  
 appuntato



09225.25  
 25°  
 18 cm



09225.45  
 45°  
 18 cm



09225.60  
 60°  
 18 cm



09225.90  
 90°  
 18 cm



09226.00  
 125°  
 18 cm

1 Blatt geknöpft  
 1 probe-pointed blade  
 1 lame boutonnée  
 1 hoja botonada  
 1 lama bottonnta

gerade  
 straight  
 droits  
 rectas  
 rette



cm	YASARGIL
16,5	09250.16
20,0	09250.20
22,5	09250.22

aufgebogen  
 upwards curved  
 courbe vers le haut  
 curvada hacia arriba  
 curvato verso l'atto

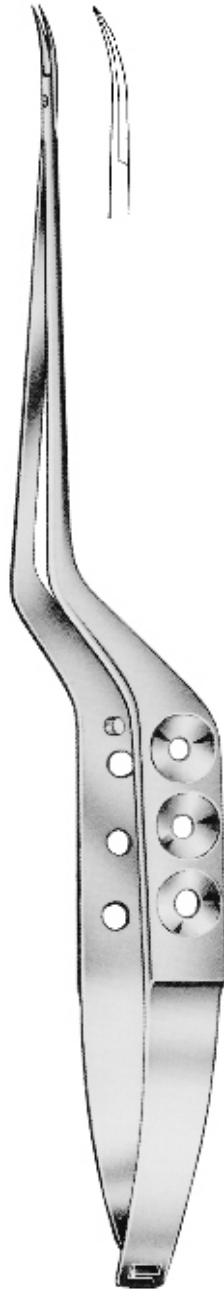

cm	YASARGIL
16,5	09251.16
20,0	09251.20
22,5	09251.22
24,5	09251.24

abwärts gebogen  
 upwards curved  
 courbe en bas  
 curvada hacia abajo  
 curvato verso il basso



cm	YASARGIL
20,0	09253.20
22,5	09253.22

stumpf  
 blunt  
 mousse  
 romo  
 smusso



cm	YASARGIL
20,0	09254.20
22,5	09254.22

stumpf  
 blunt  
 mousse  
 romo  
 smusso



cm YASARGIL  
 20,0 09255.20  
 22,5 09255.22

gebogen  
 curved  
 courbes  
 curvas  
 curve



cm JACOBSON  
 19,0 09257.19

gerade  
 straight  
 droits  
 rectas  
 rette

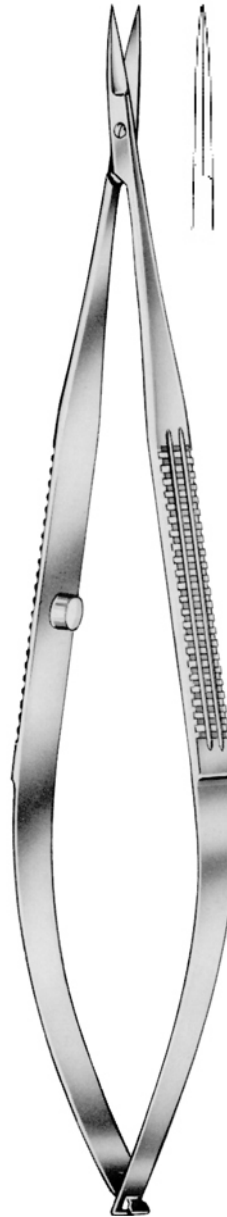

cm YASARGIL  
 12,0 09260.12  
 16,0 09260.16  
 18,0 09260.18

gebogen  
 curved  
 courbes  
 curvas  
 curve

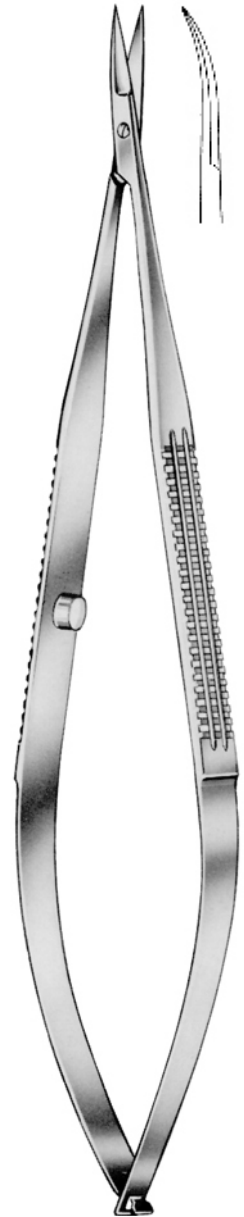

cm YASARGIL  
 12,0 09261.12  
 16,0 09261.16  
 18,0 09261.18

gerade  
straight  
droits  
rectas  
rette

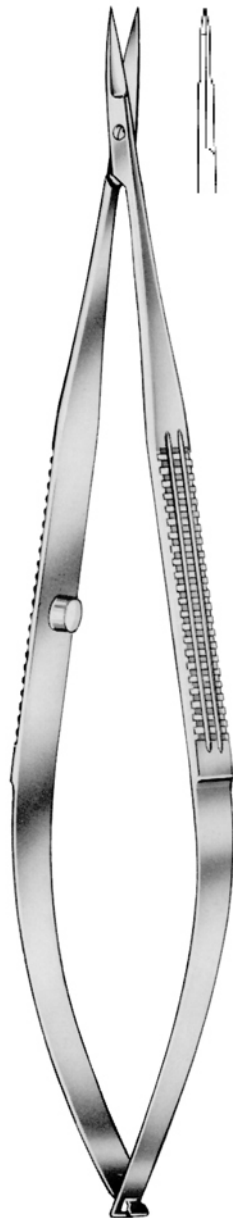

cm	VANNAS
12,0	09262.12
16,0	09262.16

gebogen  
curved  
courbes  
curvas  
curve

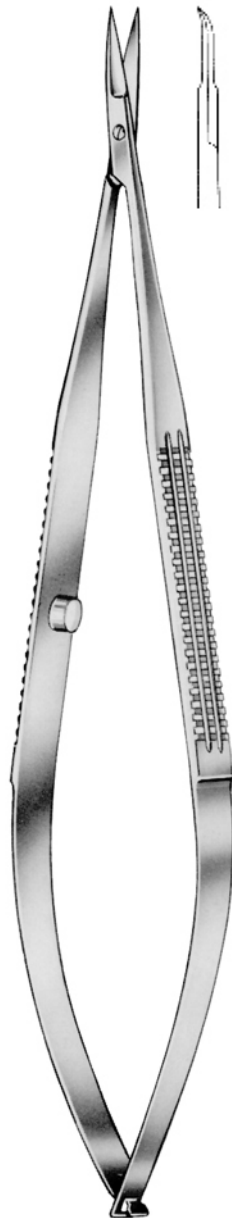

cm	VANNAS
12,0	09263.12
16,0	09263.16

gerade  
straight  
droits  
rectas  
rette



cm  
18,5 09266.18

gebogen  
curved  
courbes  
curvas  
curve



cm  
18,5 09267.18

gerade  
straight  
droits  
rectas  
rette



cm VANNAS  
18,5 09268.18

gebogen  
curved  
courbes  
curvas  
curve



cm VANNAS  
18,5 09269.18

